



# INS-RSAP

Round Straight Aluminum Pole



### Height

10' - 25'

### Pole Shaft

Round straight aluminum 6061 alloy, extruded pole shaft. Heat treated to produce a T6 temper. Ground lug welded inside hand hole opposite side of the Pole Extrusion. Pole shaft is welded to base plate on top and bottom of base plate.

### Base Plate

Manufactured from aluminum. The Base Plate vary in size from 3/4" thick for poles 10 to 20 feet, or 1" thick for poles 22 feet and over.

### Anchor Bolts

All anchor bolts are hot dipped galvanized steel and come with two galvanized nuts and washers per bolt. Minimum yield strength 50,000 psi. Anchor bolts are not included for Custom Bolt Circle.

### Base Cover

All base covers are fabricated two-piece 6063 aluminum and powder coated to match the pole. Square base cover comes standard, Round base cover optional.

### Hand-Hole

A reinforced hand-hole is 12" on center from the base plate and is constructed of 3"x 5" rectangular aluminum tubing which is welded to pole shaft for added strength. The hand-hole covers are provided with internal bridge support and powder coated to match pole finish.

### Pole Cap

All poles come with removable polymer pole cap installed. All pole caps are black finish.

### Finish

All poles are treated with sand blast media for a near white finish, power blasted with 100 psi prior to powder coat application. Poles are pre-heated then electrostatically applied polyester powder coat with a 3 to 5 mil thickness for maximum adherence.

### Marine Grade Finish

All poles are washed through a 5-stage cleaning system with a deionized rinse, a 3 to 5 mils zinc rich durable polyester primer powder coat, followed by a 3 to 5 mils super durable polyester powder coat finish.

### Anodized Under Powder

Anodized Under Powder (AUP) poles are dipped in a 3 step process for a clear anodized finish inside and outside of the pole. The final stage is electrostatically applied polyester powder coat with a 3 to 5 mil thickness for maximum adherence.

### Vibration Dampener

The Vibration Dampener is factory installed. The Vibration Dampener consists of a rugged galvanized chain coated with heavy duty polyester tubing that is factory secured at the bottom 2-3rds of the pole and field secured by contractor at the base during installation.



Project Name:

Type:

## INS-RSAP ORDERING GUIDE

Cat#	Height	Pole Dimension	Gauge	Base Pattern
Round Straight Aluminum Pole <b>(INS-RSAP)</b>	10' <b>(10)</b> 12' <b>(12)</b> 14' <b>(14)</b> 16' <b>(16)</b> 18' <b>(18)</b> 20' <b>(20)</b> 22' <b>(22)</b> 24' <b>(24)</b> 25' <b>(25)</b>	4" Round <b>(4R)</b>  5" Round <b>(5R)</b>  6" Round <b>(6R)</b>	.120 Wall Thickness <b>(120)</b>  .188 Wall Thickness <b>(188)</b>  .25 Wall Thickness <b>(250)</b>	(10'-20') 8 3/16"- 10 3/16" Bolt Circle <b>(9BC)</b>  (22'-Over) 11 1/2"- 14" Bolt Circle <b>(12BC)</b>  Custom Bolt Circle <b>(CBC)</b> <i>* Consult Factory</i>

Mounting	Color	Bolts	Options
Single <b>(SGL)</b>	Bronze Textured <b>(BRZ)</b>	3/4" x 30" <b>(3430)</b>	GFI Kit <b>(GF120A)</b> 20 Amp <i>Weather Proof Receptacle</i>
Double <b>(D-90)</b> <b>(D-180)</b>	White Textured <b>(WHT)</b>	1" x 36" <b>(136)</b>	GFI Provision Only <b>(PROV)</b>
Triple <b>(T-90)</b>	Smooth White Gloss <b>(SWT)</b>	Less Anchor Bolts <b>(LAB)</b>	Round Base Cover <b>(RBC)</b> <i>*Consult Factory for Pricing</i>
Quad <b>(QD)</b>	Silver <b>(SVR)</b>		1/2" Coupling <b>(COUP)</b> <i>* Specify Location</i>
No Drill <b>(ND)</b> <i>*Tenon Option</i>	Green Textured <b>(GRN)</b>		Vibration Dampener <b>(VD)</b>
<b>Tenon</b>	Hunter Green Textured <b>(HGN)</b>		Extra Hand Hole <b>(XHH)</b> <i>* Specify Location</i>
2 3/8" Round <b>(T2R)</b>	Black Textured <b>(BLK)</b>		Marine Grade Finish <b>(MGF)</b>
3" Round <b>(T3R)</b>	Smooth Black Gloss <b>(SBK)</b>		Anodized Under Powder <b>(AUP)</b>
3 1/2" Round <b>(T312R)</b>	Graphite Textured <b>(GPH)</b>		
4 1/2" Round <b>(T412R)</b>	Grey Textured <b>(GRY)</b>		
	Custom <b>(CS)</b>		



1862 Sparkman Drive NW, Huntsville, AL 35816  
Call Us Today (256) 801-9825

[energysolutions.net](http://energysolutions.net)

Max. allowable EPA - RSAP poles (per AASHTO LRFDLTS-1)

Catalog Number	Shaft Length, ft	Wall thickness, in.	Shaft dia., in.	Base Plate, in.	Bolt Circle, in.	Bolts	80 mph	Max. wt. (lb)	90 mph	Max. wt. (lb)	100 mph	Max. wt. (lb)	110 mph	Max. wt. (lb)	115 mph	Max. wt. (lb)	120 mph	Max. wt. (lb)	130 mph	Max. wt. (lb)	140 mph	Max. wt. (lb)	150 mph	Max. wt. (lb)	160 mph	Max. wt. (lb)	170 mph	Max. wt. (lb)	180 mph	Max. wt. (lb)
INS-RSAP-10-4R-120-9BC-3430	10	0.120	4	9" sq.	9	3/4"x30"	8.8	220	6.5	163	4.9	123	3.7	93	3.3	83	2.8	70	2.1	60	1.6	60	1.2	60	0.9	60	0.8	60	0.6	60
INS-RSAP-12-4R-120-9BC-3430	12	0.120	4	9" sq.	9	3/4"x30"	6.5	163	4.6	115	3.3	83	2.3	60	1.9	60	1.5	60	0.9	60	0.5	60	0.2	60	-	-	-	-	-	-
INS-RSAP-14-4R-120-9BC-3430	14	0.120	4	9" sq.	9	3/4"x30"	4.6	115	3.2	80	2.0	60	1.2	60	0.8	60	0.5	60	-	-	-	-	-	-	-	-	-	-	-	-
INS-RSAP-15-4R-120-9BC-3430	15	0.120	4	9" sq.	9	3/4"x30"	3.9	98	2.5	63	1.4	60	0.7	60	0.4	60	-	-	-	-	-	-	-	-	-	-	-	-	-	-
INS-RSAP-16-4R-120-9BC-3430	16	0.120	4	9" sq.	9	3/4"x30"	3.0	75	1.7	60	0.8	60	0.2	60	-	-	-	-	-	-	-	-	-	-	-	-	-	-	-	-
INS-RSAP-18-4R-120-9BC-3430	18	0.120	4	9" sq.	9	3/4"x30"	1.8	60	0.7	60	-	-	-	-	-	-	-	-	-	-	-	-	-	-	-	-	-	-	-	-
INS-RSAP-10-5R-120-9BC-3430	10	0.120	5	9" sq.	9	3/4"x30"	15.2	380	11.5	288	8.7	218	6.7	168	6.0	150	5.3	133	4.4	110	3.7	93	3.2	80	2.8	70	2.4	60	2.1	60
INS-RSAP-12-5R-120-9BC-3430	12	0.120	5	9" sq.	9	3/4"x30"	11.6	290	8.5	213	6.3	158	4.6	115	4.0	100	3.6	90	2.9	73	2.4	60	2.0	60	1.7	60	1.4	60	1.2	60
INS-RSAP-14-5R-120-9BC-3430	14	0.120	5	9" sq.	9	3/4"x30"	8.8	220	6.2	155	4.3	108	3.1	78	2.5	63	2.1	60	1.6	60	1.3	60	1.0	60	0.8	60	0.6	60	0.5	60
INS-RSAP-15-5R-120-9BC-3430	15	0.120	5	9" sq.	9	3/4"x30"	7.7	193	5.2	130	3.6	90	2.3	60	1.8	60	1.5	60	1.1	60	0.8	60	0.6	60	0.4	60	0.2	60	-	-
INS-RSAP-16-5R-120-9BC-3430	16	0.120	5	9" sq.	9	3/4"x30"	6.2	155	4.0	100	2.6	65	1.5	60	1.1	60	0.8	60	0.5	60	0.3	60	-	-	-	-	-	-	-	-
INS-RSAP-18-5R-120-9BC-3430	18	0.120	5	9" sq.	9	3/4"x30"	4.4	110	2.6	65	1.3	60	0.3	60	-	-	-	-	-	-	-	-	-	-	-	-	-	-	-	-
INS-RSAP-10-6R-120-9BC-3430	10	0.120	6	9" sq.	9	3/4"x30"	20.0	500	17.6	440	13.8	345	11.2	280	10.2	255	9.3	233	7.7	193	6.5	163	5.6	140	4.9	123	4.2	105	3.7	93
INS-RSAP-12-6R-120-9BC-3430	12	0.120	6	9" sq.	9	3/4"x30"	18.0	450	13.5	338	10.3	258	8.2	205	7.4	185	6.7	168	5.6	140	4.7	118	4.0	100	3.5	88	3.0	75	2.7	68
INS-RSAP-14-6R-120-9BC-3430	14	0.120	6	9" sq.	9	3/4"x30"	14.1	353	10.3	258	7.6	190	6.1	153	5.5	138	4.9	123	4.0	100	3.3	83	2.8	70	2.3	60	2.0	60	1.7	60
INS-RSAP-15-6R-120-9BC-3430	15	0.120	6	9" sq.	9	3/4"x30"	12.6	315	9.0	225	6.5	163	5.1	128	4.6	115	4.1	103	3.3	83	2.7	68	2.2	60	1.9	60	1.6	60	1.3	60
INS-RSAP-16-6R-120-9BC-3430	16	0.120	6	9" sq.	9	3/4"x30"	10.3	258	7.2	180	5.1	128	4.0	100	3.5	88	3.1	78	2.5	63	2.0	60	1.6	60	1.3	60	1.1	60	0.9	60
INS-RSAP-18-6R-120-9BC-3430	18	0.120	6	9" sq.	9	3/4"x30"	7.9	198	5.2	130	3.3	83	2.5	63	2.1	60	1.8	60	1.4	60	1.0	60	0.7	60	0.5	60	0.4	60	0.2	60

\*Pole Assemblies With EPA>9.0 Require Specific Review

**CAUTION: Installation of poles without luminaire(s) will compromise pole strength. Any accessories attached to the pole, or other modifications done in the field, will compromise the pole strength and may result in pole failure. Wind load evaluations and provisions for appendages such as banner arms, signage, cameras, etc., must be evaluated and approved by the factory prior to placing an order. Additional evaluation and approval should be performed by the customer's local structural engineer on the project.**

**\*Anchor Bolts are NOT included with Custom Bolt Circle.  
\*Do NOT pour concrete referencing this drawing. Consult Factory.**

**\*All wind loading calculations are based on sustained wind force plus an additional 1.3 gust.**

MOUNTING CONFIGURATION



Single  
(SGL)

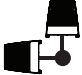

Double  
(D-90)



Double  
(D-180)

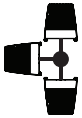

Triple  
(T-90)

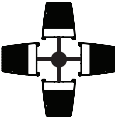

Quad  
(QD)



1862 Sparkman Drive NW, Huntsville, AL 35816  
Call Us Today (256) 801-9825

**energysolutions.net**

Max. allowable EPA - RSAP poles (per AASHTO LRFDLTS-1)

Catalog Number	Shaft Length, ft	Wall thickness, in.	Shaft dia., in.	Base Plate, in.	Bolt Circle, in.	Bolts	80 mph	Max. wt. (lb)	90 mph	Max. wt. (lb)	100 mph	Max. wt. (lb)	110 mph	Max. wt. (lb)	115 mph	Max. wt. (lb)	120 mph	Max. wt. (lb)	130 mph	Max. wt. (lb)	140 mph	Max. wt. (lb)	150 mph	Max. wt. (lb)	160 mph	Max. wt. (lb)	170 mph	Max. wt. (lb)	180 mph	Max. wt. (lb)
INS-RSAP-10-4R-188-9BC-3430	10	0.188	4	9" sq.	9	3/4"x30"	14.4	360	11.0	275	8.5	213	6.7	168	5.9	148	5.3	133	4.2	105	3.3	83	2.7	68	2.3	60	2.0	60	1.7	60
INS-RSAP-10-5R-188-9BC-3430	10	0.188	5	9" sq.	9	3/4"x30"	20.0	500	18.7	468	14.7	368	11.7	293	10.5	263	9.5	238	8.0	200	6.8	170	5.8	145	5.0	125	4.4	110	3.9	98
INS-RSAP-10-6R-188-9BC-3430	10	0.188	6	9" sq.	9	3/4"x30"	20.0	500	20.0	500	20.0	500	18.4	460	16.8	420	15.4	385	13.0	325	11.1	278	9.6	240	8.3	208	7.3	183	6.5	163
INS-RSAP-12-4R-188-9BC-3430	12	0.188	4	9" sq.	9	3/4"x30"	11.2	280	8.2	205	6.2	155	4.7	118	4.1	103	3.6	90	2.7	68	2.0	60	1.5	60	1.3	60	1.0	60	0.9	60
INS-RSAP-12-5R-188-9BC-3430	12	0.188	5	9" sq.	9	3/4"x30"	19.3	483	14.6	365	11.3	283	8.7	218	7.7	193	6.9	173	5.7	143	4.8	120	4.1	103	3.6	90	3.1	78	2.7	68
INS-RSAP-12-6R-188-9BC-3430	12	0.188	6	9" sq.	9	3/4"x30"	20.0	500	20.0	500	17.6	440	14.4	360	13.1	328	11.9	298	10.0	250	8.4	210	7.2	180	6.3	158	5.5	138	4.8	120
INS-RSAP-14-4R-188-9BC-3430	14	0.188	4	9" sq.	9	3/4"x30"	8.6	215	6.2	155	4.5	113	3.3	83	2.8	70	2.3	60	1.5	60	0.9	60	0.5	60	0.4	60	0.2	60	-	-
INS-RSAP-14-5R-188-9BC-3430	14	0.188	5	9" sq.	9	3/4"x30"	15.4	385	11.4	285	8.6	215	6.5	163	5.6	140	5.0	125	4.1	103	3.4	85	2.8	70	2.4	60	2.0	60	1.7	60
INS-RSAP-14-6R-188-9BC-3430	14	0.188	6	9" sq.	9	3/4"x30"	20.0	500	18.0	450	13.9	348	11.2	280	10.2	255	9.3	233	7.7	193	6.5	163	5.6	140	4.8	120	4.2	105	3.6	90
INS-RSAP-16-4R-188-9BC-3430	16	0.188	4	9" sq.	9	3/4"x30"	6.1	153	4.2	105	2.9	73	1.9	60	1.4	60	1.1	60	0.5	60	-	-	-	-	-	-	-	-	-	-
INS-RSAP-16-5R-188-9BC-3430	16	0.188	5	9" sq.	9	3/4"x30"	11.6	290	8.2	205	5.9	148	4.2	105	3.6	90	3.1	78	2.5	63	2.0	60	1.6	60	1.3	60	1.1	60	0.9	60
INS-RSAP-16-6R-188-9BC-3430	16	0.188	6	9" sq.	9	3/4"x30"	18.3	458	13.5	338	10.2	255	8.2	205	7.4	185	6.6	165	5.5	138	4.6	115	3.9	98	3.3	83	2.8	70	2.4	60
INS-RSAP-18-4R-188-9BC-3430	18	0.188	4	9" sq.	9	3/4"x30"	4.5	113	2.9	73	1.7	60	0.8	60	0.4	60	-	-	-	-	-	-	-	-	-	-	-	-	-	-
INS-RSAP-18-5R-188-9BC-3430	18	0.188	5	9" sq.	9	3/4"x30"	9.2	230	6.2	155	4.2	105	2.8	70	2.2	60	1.8	60	1.3	60	1.0	60	0.7	60	0.5	60	0.3	60	0.2	60
INS-RSAP-18-6R-188-9BC-3430	18	0.188	6	9" sq.	9	3/4"x30"	15.0	375	10.7	268	7.8	195	6.2	155	5.5	138	5.0	125	4.0	100	3.3	83	2.7	68	2.3	60	1.9	60	1.6	60
INS-RSAP-20-4R-188-9BC-3430	20	0.188	4	9" sq.	9	3/4"x30"	3.2	80	1.7	60	0.6	60	-	-	-	-	-	-	-	-	-	-	-	-	-	-	-	-	-	-
INS-RSAP-20-5R-188-9BC-3430	20	0.188	5	9" sq.	9	3/4"x30"	7.0	175	4.5	113	2.8	70	1.5	60	0.9	60	0.6	60	0.3	60	-	-	-	-	-	-	-	-	-	-
INS-RSAP-20-6R-188-9BC-3430	20	0.188	6	9" sq.	9	3/4"x30"	12.1	303	8.3	208	5.8	145	4.5	113	4.0	100	3.5	88	2.8	70	2.2	60	1.7	60	1.4	60	1.1	60	0.9	60
INS-RSAP-22-5R-188-12BC-136	22	0.188	5	12" sq.	12	1"x36"	4.7	118	2.7	68	1.3	60	0.2	60	-	-	-	-	-	-	-	-	-	-	-	-	-	-	-	-
INS-RSAP-22-6R-188-12BC-136	22	0.188	6	12" sq.	12	1"x36"	8.8	220	5.6	140	3.7	93	2.7	68	2.3	60	2.0	60	1.5	60	1.1	60	0.8	60	0.6	60	0.4	60	0.2	60
INS-RSAP-25-5R-188-12BC-136	25	0.188	5	12" sq.	12	1"x36"	2.5	63	0.8	60	-	-	-	-	-	-	-	-	-	-	-	-	-	-	-	-	-	-	-	-
INS-RSAP-25-6R-188-12BC-136	25	0.188	6	12" sq.	12	1"x36"	5.8	145	3.1	78	1.3	60	0.7	60	0.5	60	0.3	60	-	-	-	-	-	-	-	-	-	-	-	-

\*Pole Assemblies With EPA>9.0 Require Specific Review



1862 Sparkman Drive NW, Huntsville, AL 35816  
Call Us Today (256) 801-9825

[Inergysolutions.net](http://Inergysolutions.net)

Max. allowable EPA - RSAP poles (per AASHTO LRFDLTS-1)

Catalog Number	Shaft Length, ft	Wall thickness, in.	Shaft dia., in.	Base Plate, in.	Bolt Circle, in.	Boils	80 mph	Max. wt. (lb)	90 mph	Max. wt. (lb)	100 mph	Max. wt. (lb)	110 mph	Max. wt. (lb)	115 mph	Max. wt. (lb)	120 mph	Max. wt. (lb)	130 mph	Max. wt. (lb)	140 mph	Max. wt. (lb)	150 mph	Max. wt. (lb)	160 mph	Max. wt. (lb)	170 mph	Max. wt. (lb)	180 mph	Max. wt. (lb)
INS-RSAP-12-4R-250-9BC-3430	12	0.250	4	9" sq.	9	3/4"x30"	15.0	375	11.3	283	8.6	215	6.7	168	5.9	148	5.2	130	4.1	103	3.3	83	2.6	65	2.2	60	1.9	60	1.6	60
INS-RSAP-12-5R-250-9BC-3430	12	0.250	5	9" sq.	9	3/4"x30"	20.0	500	19.7	493	15.4	385	12.2	305	10.9	273	9.8	245	8.1	203	6.9	173	5.9	148	5.1	128	4.4	110	3.9	98
INS-RSAP-14-4R-250-9BC-3430	14	0.250	4	9" sq.	9	3/4"x30"	11.9	298	8.7	218	6.5	163	4.9	123	4.2	105	3.7	93	2.8	70	2.0	60	1.5	60	1.2	60	1.0	60	0.8	60
INS-RSAP-14-5R-250-9BC-3430	14	0.250	5	9" sq.	9	3/4"x30"	20.0	500	15.8	395	12.1	303	9.4	235	8.2	205	7.3	183	6.1	153	5.1	128	4.3	108	3.7	93	3.3	83	2.8	70
INS-RSAP-14-6R-250-9BC-3430	14	0.250	6	9" sq.	9	3/4"x30"	20.0	500	20.0	500	19.2	480	15.7	393	14.2	355	13.0	325	10.9	273	9.3	233	7.9	198	6.8	170	5.9	148	5.2	130
INS-RSAP-16-4R-250-9BC-3430	16	0.250	4	9" sq.	9	3/4"x30"	8.7	218	6.2	155	4.5	113	3.2	80	2.7	68	2.2	60	1.5	60	0.8	60	0.4	60	0.3	60	-	-	-	-
INS-RSAP-16-5R-250-9BC-3430	16	0.250	5	9" sq.	9	3/4"x30"	16.0	400	11.8	295	8.8	220	6.6	165	5.7	143	5.0	125	4.1	103	3.5	88	2.9	73	2.4	60	2.1	60	1.8	60
INS-RSAP-16-6R-250-9BC-3430	16	0.250	6	9" sq.	9	3/4"x30"	20.0	500	18.8	470	14.5	363	11.7	293	10.6	265	9.6	240	8.0	200	6.8	170	5.8	145	5.0	125	4.3	108	3.8	95
INS-RSAP-18-4R-250-9BC-3430	18	0.250	4	9" sq.	9	3/4"x30"	6.8	170	4.7	118	3.1	78	2.0	60	1.5	60	1.1	60	0.4	60	-	-	-	-	-	-	-	-	-	-
INS-RSAP-18-5R-250-9BC-3430	18	0.250	5	9" sq.	9	3/4"x30"	13.0	325	9.4	235	6.8	170	4.8	120	4.0	100	3.5	88	2.8	70	2.2	60	1.8	60	1.4	60	1.1	60	0.9	60
INS-RSAP-18-6R-250-9BC-3430	18	0.250	6	9" sq.	9	3/4"x30"	20.0	500	15.4	385	11.6	290	9.3	233	8.4	210	7.6	190	6.3	158	5.2	130	4.4	110	3.8	95	3.2	80	2.8	70
INS-RSAP-20-4R-250-9BC-3430	20	0.250	4	9" sq.	9	3/4"x30"	5.1	128	3.3	83	1.9	60	0.9	60	0.5	60	0.2	60	-	-	-	-	-	-	-	-	-	-	-	-
INS-RSAP-20-5R-250-9BC-3430	20	0.250	5	9" sq.	9	3/4"x30"	17.5	438	12.8	320	9.4	235	7.1	178	6.0	150	5.3	133	4.3	108	3.5	88	2.8	70	2.4	60	2.0	60	1.8	60
INS-RSAP-20-6R-250-9BC-3430	20	0.250	6	9" sq.	9	3/4"x30"	20.0	500	19.5	488	14.7	368	11.8	295	10.8	270	9.8	245	7.9	198	6.7	168	5.9	148	4.8	120	4.2	105	3.7	91
INS-RSAP-22-5R-250-12BC-136	22	0.250	5	12" sq.	12	1"x36"	7.6	190	4.9	123	3.1	78	1.7	60	1.1	60	0.8	60	0.4	60	0.2	60	-	-	-	-	-	-	-	-
INS-RSAP-22-6R-250-12BC-136	22	0.250	6	12" sq.	12	1"x36"	13.3	333	9.2	230	6.4	160	4.9	123	4.4	110	3.9	98	3.2	80	2.5	63	2.0	60	1.7	60	1.4	60	1.1	60
INS-RSAP-25-5R-250-12BC-136	25	0.250	5	12" sq.	12	1"x36"	4.9	123	2.7	68	1.1	60	-	-	-	-	-	-	-	-	-	-	-	-	-	-	-	-	-	
INS-RSAP-25-6R-250-12BC-136	25	0.250	6	12" sq.	12	1"x36"	9.6	240	6.1	153	3.8	95	2.7	68	2.3	60	2.0	60	1.4	60	1.0	60	0.7	60	0.4	60	0.2	60	0.1	60

\*Pole Assemblies With EPA>9.0 Require Specific Review



1862 Sparkman Drive NW, Huntsville, AL 35816  
Call Us Today (256) 801-9825

[energysolutions.net](http://energysolutions.net)

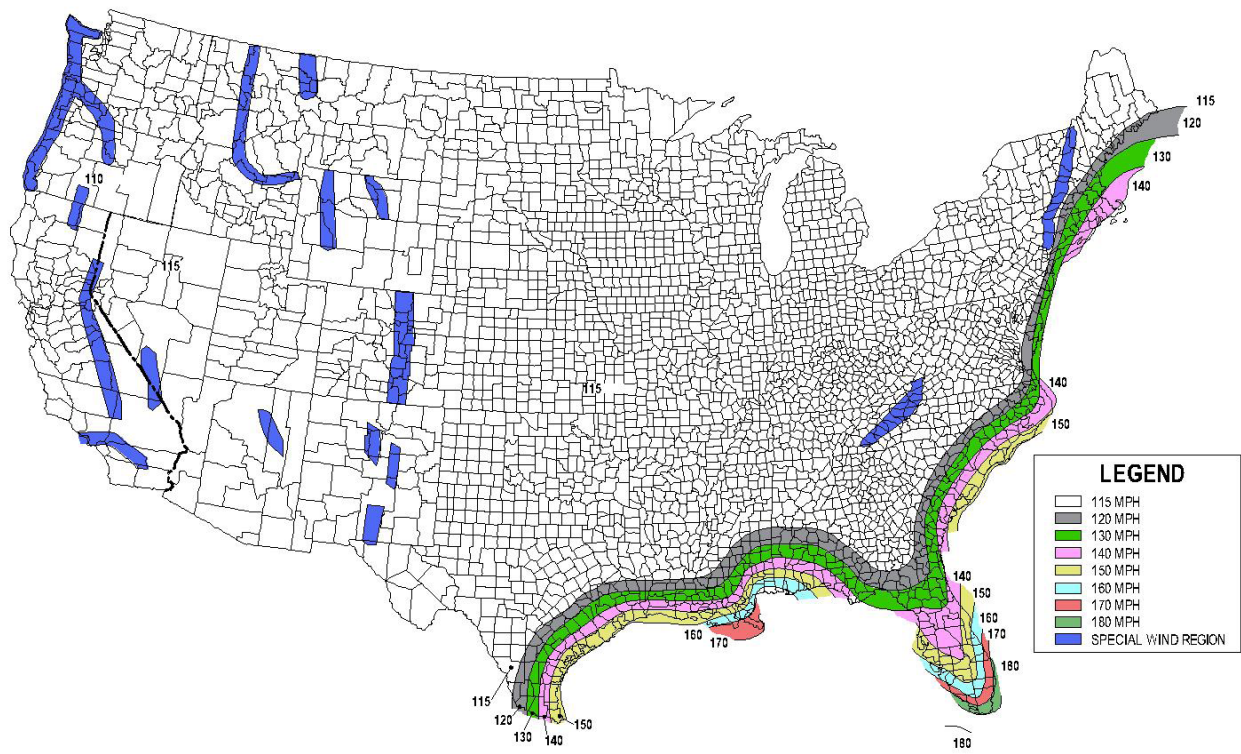
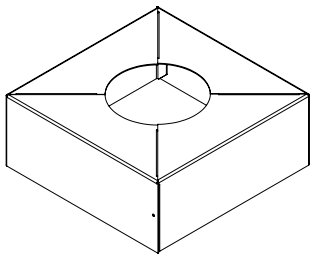
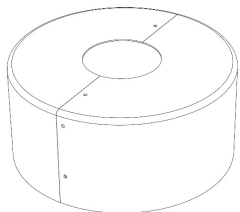

FIG. 3.8-1b - 700-Year MRI Basic Wind Speed, mph (AASHTO LRFDLTS-1)

- 1) All wind load calculations are based on sustained wind force plus and additional 1.3 gust
- 2) Wind Map is to be used as a reference only. Please coordinate with local agencies for further review.
- 3) Wind Map values are based on a 50 year mean recurrence. These values do not account for severe conditions, such as hurricanes, tornadoes, etc...
- 4) For review of poles with additional configurations (arms, banners, shorter/longer pole lengths, etc...), please contact factory.



**Base Cover**



**Optional Round Base Cover**

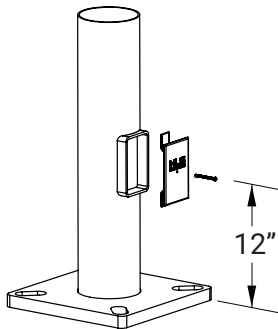

**Base Detail**

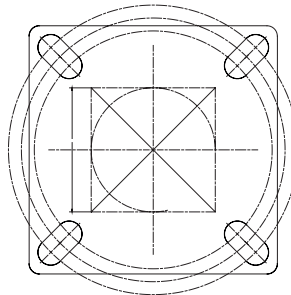

**12" Base Detail**

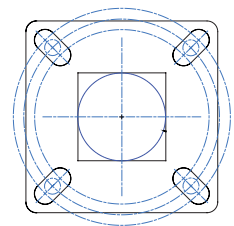

**9" Base Detail**



1862 Sparkman Drive NW, Huntsville, AL 35816  
Call Us Today (256) 801-9825

[energysolutions.net](http://energysolutions.net)